

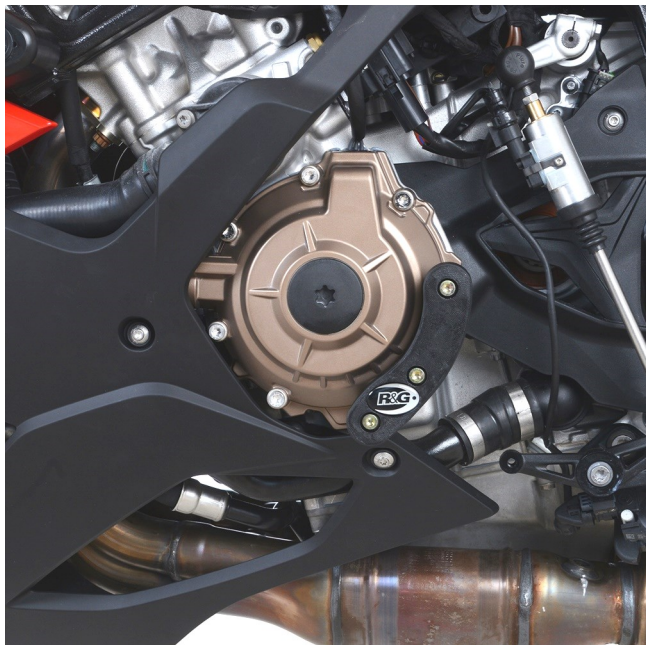

FITTING INSTRUCTIONS FOR ECS0141BK LEFT-HAND SIDE ENGINE CASE SLIDER



Picture A



Picture B

THIS KIT CONTAINS THE ITEMS PICTURED AND LABELLED OVER PAGE.

SOME PARTS MAY BE SHOWN FOR CLARITY OF INSTRUCTIONS ONLY.

DO NOT PROCEED UNTIL YOU ARE SURE ALL PARTS ARE PRESENT.

PLEASE READ ALL INSTRUCTIONS BEFORE PROCEEDING.

PLEASE NOTE THAT THE WAY THE KIT IS PACKED DOES NOT NECESSARILY REPRESENT THE WAY OF MOUNTING TO THE BIKE.

IN THE EVENT OF RUBBER WASHERS BEING USED TO HOLD COMPONENTS ONTO BOLTS,
THESE RUBBER WASHERS CAN BE THROWN AWAY.

DIGITAL COPIES OF THESE INSTRUCTIONS ARE AVAILABLE FROM:

WWW.RG-RACING.COM

R&G Racing

Unit 1, Shelleys Lane, East Worldham, Alton, Hampshire GU34 3AQ.

Tel: +44 (0)1420 89007 Fax +44 (0)1420 87301 www.rg-racing.com Email: info@rg-racing.com



<u>TOOLS REQUIRED</u>	<u>GENERAL TORQUE SETTINGS</u>
<ul style="list-style-type: none"> • T30 Torx Tool • 5mm A/F Allen Tool • Torque Wrench 	<p>M4 BOLT = 8Nm</p> <p>M5 BOLT = 12Nm</p> <p>M6 BOLT = 15Nm</p> <p>M8 BOLT = 20Nm</p> <p>M10 BOLT = 40Nm</p> <p>M12 BOLT = 40Nm</p>

LEGEND

ITEM No.	DESCRIPTION	QTY
ITEM 1	ECS0141 H.D.P.E. ENGINE CASE SLIDER (FITTED WITH 3x CS529 COMPRESSION SLEEVES)	1
ITEM 2	M6 x 1.0 x 60.0mm STAINLESS STEEL CAP HEAD BOLT	3
ITEM 3	M6 WASHER (12mm O/D)	3

EXPLODED ASSEMBLY DIAGRAM

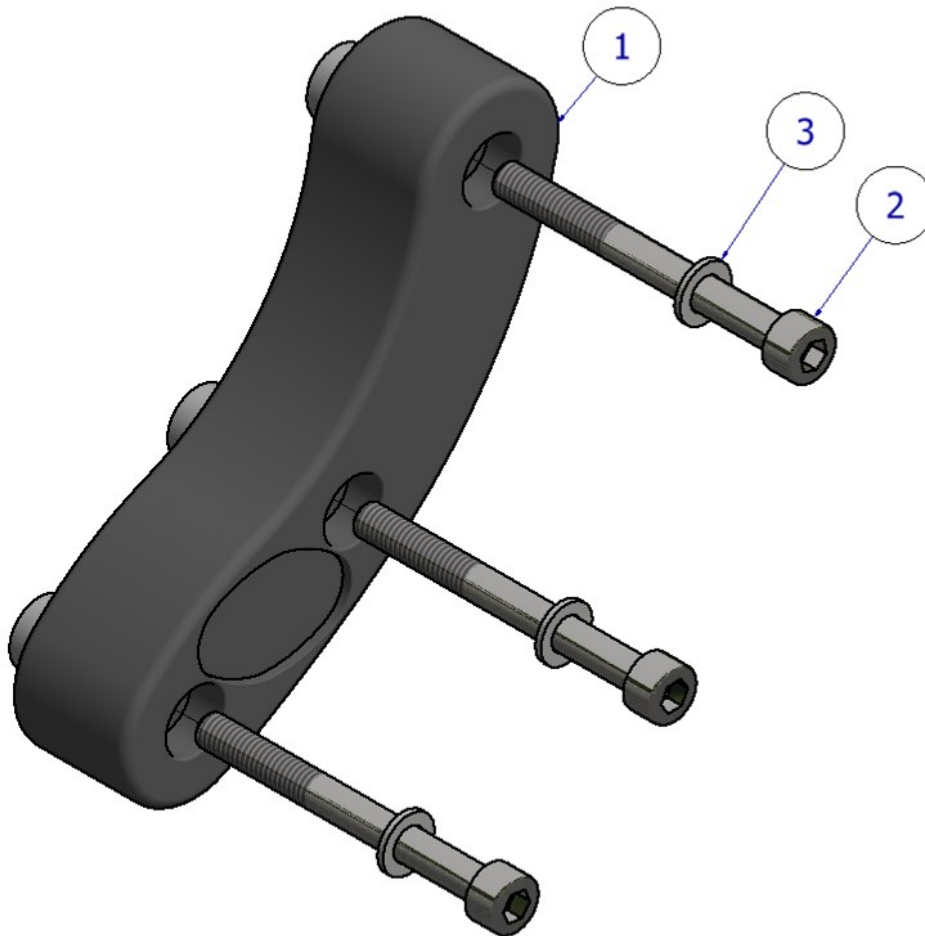

R&G Racing

Unit 1, Shelleys Lane, East Worldham, Alton, Hampshire GU34 3AQ.

Tel: +44 (0)1420 89007 Fax +44 (0)1420 87301 www.rg-racing.com Email: info@rg-racing.com

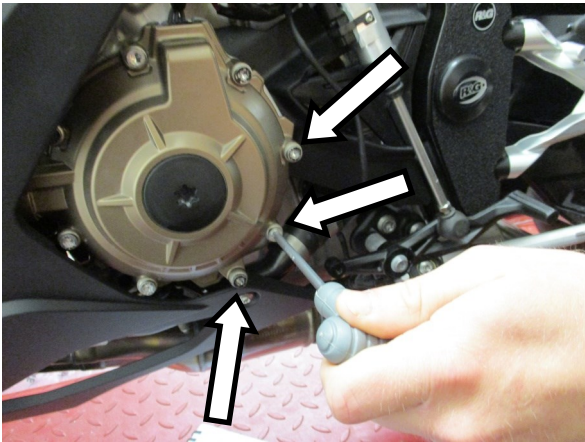

Picture 1

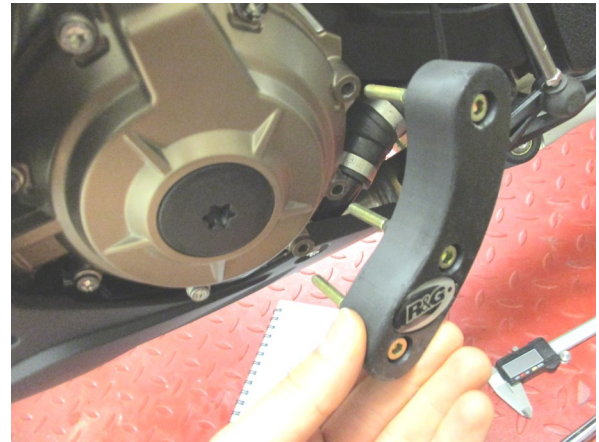

Picture 2



Picture 3



Picture 4

FITTING INSTRUCTIONS

- Remove the 3x T30 engine case bolts shown in picture 1.
- Referring to the diagram on page 2 as well as picture 2, pre-assemble the R&G engine case slider. Slide a washer (item 3) over each of the 3 cap-head bolts (item 2), then slide each bolt assembly through the 3 recessed mounting holes in the engine case slider (item 1).
- Offer the assembled slider up to the engine case as shown in picture 2, then secure using a 5mm Allen key as shown in picture 3, finally fully tightening to the manufacturers specified torque.
- If not already fitted, attach one of the included R&G bubble stickers to the slider.

R&G Racing

Unit 1, Shelleys Lane, East Worldham, Alton, Hampshire GU34 3AQ.

Tel: +44 (0)1420 89007 Fax +44 (0)1420 87301 www.rg-racing.com Email: info@rg-racing.com



CONSUMER NOTICE

The catalogue description and any exhibition of samples are only broad indications of the Products and R&G may make design changes which do not diminish their performance or visual appeal and supplying them in such state shall conform to the order. The Buyer acknowledges no representation or warranty (other than as to title) has been given or will apply to the Products other than those in R&G's order or confirmation and the Buyer confirms it has chosen the Products as being of merchantable quality and suitable for its particular purposes. Where R&G fits the Products or undertakes other services it shall exercise reasonable skill and care and rectify any fault free of charge unless the workmanship has been disturbed. The Buyer is responsible for ensuring that the warranty on the motorcycle is not affected by the fitting of the Products. On return of any defective Products R&G shall at its option either supply a replacement or refund the purchase money but shall not be liable if the Products have been modified or used or maintained otherwise than in accordance with R&G's or manufacturer's instructions and good engineering practice or if the defect arises from accident or neglect. Other than identified above and subject to R&G not limiting its liability for causing death and personal injury, it shall not be liable for indirect or consequential loss and otherwise its liability shall be limited to the amounts paid by the Buyer for the Products or the fitting or service concerned. These terms do not affect the Buyer's statutory rights.

R&G RETURNS POLICY (NON-FAULTY GOODS)

Returns must be pre-authorized (if not pre-authorized the return will be rejected). Goods may only be returned direct to us if they were purchased direct from us (customer must prove if necessary). Otherwise to be returned to original vendor. Goods must be in re-sellable condition, in the opinion of R&G. All returns are subject to a 25% restocking and handling fee (25% of the gross value exc. P&P – at the prevailing price at time of purchase). The customer must pay any and all carriage charges. No returns of discontinued products, unless within 14 days of purchase. This policy does not affect your statutory rights and does not refer to faulty goods.

R&G Racing

Unit 1, Shelleys Lane, East Worldham, Alton, Hampshire GU34 3AQ.

Tel: +44 (0)1420 89007 Fax +44 (0)1420 87301 www.rg-racing.com Email: info@rg-racing.com



NOTICE DE MONTAGE POUR ECS0141BK PROTECTION CARTER MOTEUR GAUCHE BMW S1000RR 2019



Photo A



Photo B

LE KIT CONTIENT LES ARTICLES EN PHOTO ET ETIQUETTES SUR LA PAGE

LES PARTIES PRÉSENTÉES PEUVENT ÊTRE UNIQUEMENT REPRESENTATIVES POUR LA CLARTE DES INSTRUCTIONS

NE PAS PROCÉDER AU MONTAGE AVANT DE VOUS ÊTRE ASSURÉ QUE TOUTES LES PIÈCES SOIENT PRÉSENTES.

SVP, LIRE L'ENSEMBLE DE LA NOTICE AVANT DE PROCÉDER AU MONTAGE.

LA FAÇON DONT LE KIT EST EMBALLÉ NE CORRESPOND PAS FORCÉMENT À LA FAÇON DE MONTER LES PIÈCES SUR LA MOTO .

NOTEZ QUE SI LES KITS SONT EMBALLÉS AVEC DES RONDELLES EN CAOUTCHOUC SERVANT À TENIR LES COMPOSANTS, CES RONDELLES DOIVENT ÊTRE JETÉES.

NOTICE DISPONIBLE AU TÉLÉCHARGEMENT SUR : WWW.RG-RACING.COM

R&G Racing

Unit 1, Shelleys Lane, East Worldham, Alton, Hampshire GU34 3AQ.

Tel: +44 (0)1420 89007 Fax +44 (0)1420 87301 www.rg-racing.com Email: info@rg-racing.com



<u>OUTILS REQUIS</u>	<u>GENERAL TORQUE SETTINGS</u>
<ul style="list-style-type: none"> • Clé Torx T30 • Clé Allen 5mm • Clé Torx 	M4 BOULON = 8Nm M5 BOULON = 12Nm M6 BOULON = 15Nm M8 BOULON = 20Nm M10 BOULON = 40Nm M12 BOULON = 40Nm

LEGENDE

ARTICLE No.	DESCRIPTION	QTE
ARTICLE 1	ECS0141 H.D.P.E. PROTECTION CARTER MOTEUR (AVEC 3x CS529 MANCHON DE COMPRESSION)	1
ARTICLE 2	M6 x 1.0 x 60.0mm BOULON	3
ARTICLE 3	M6 RONDELLE (12mm)	3

SCHEMA

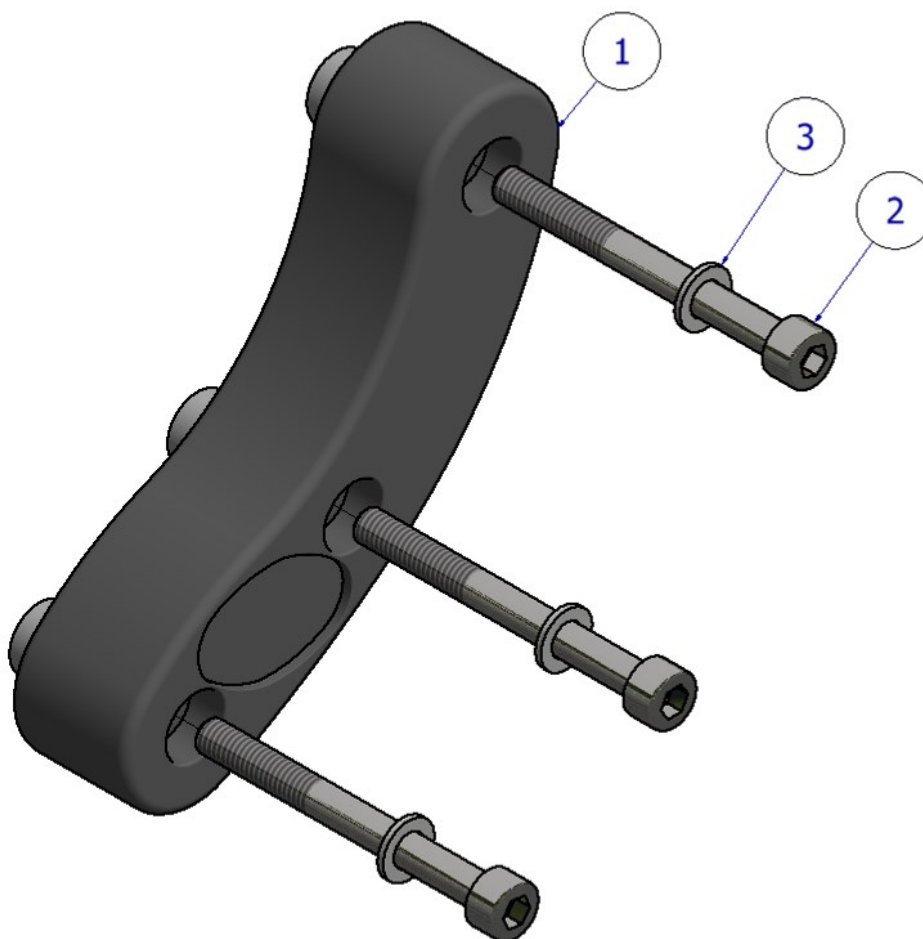

R&G Racing

Unit 1, Shelleys Lane, East Worldham, Alton, Hampshire GU34 3AQ.

Tel: +44 (0)1420 89007 Fax +44 (0)1420 87301 www.rg-racing.com Email: info@rg-racing.com

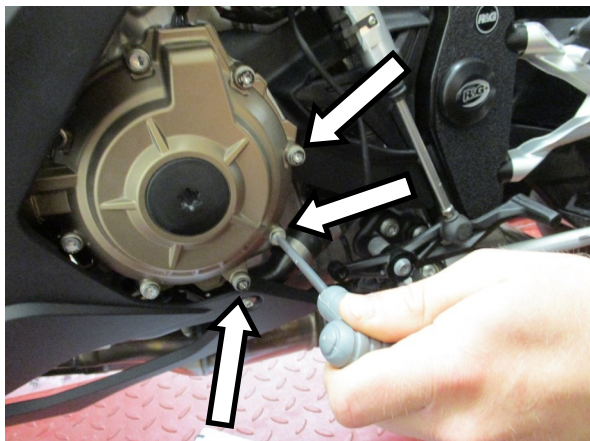

Photo 1

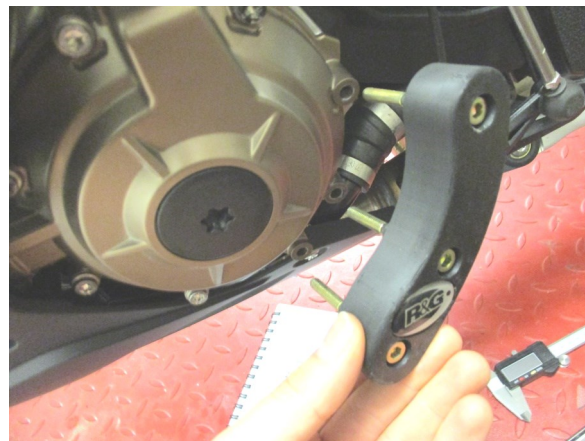

Photo 2



Photo 3

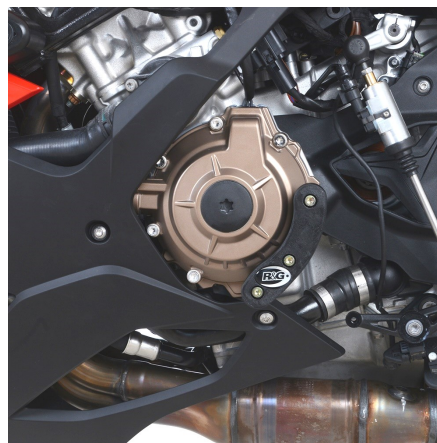

Photo 4

NOTICE DE MONTAGE

- Enlever les 3 boulons Torx T30 de carter moteur, voir photo 1.
- En vous référant au schéma de la page 2, photo 2, pré-assembler la protection de carter moteur R&G. Faites glisser une rondelle (article 3) sur chacun des 3 boulons (article 2), puis faites glisser chaque boulon à travers les 3 trous de montage de la protection de carter de moteur (article 1).
- Montez la protection sur le carter moteur comme indiqué sur la photo 2, puis fixez-la à l'aide d'une clé Allen de 5 mm comme indiqué sur la photo 3, et resserrez enfin au couple spécifié par le fabricant.
- Si cela n'est pas déjà fait, collez l'un des stickers en caoutchouc R&G inclus dans la protection.

ISSUE 1 - 23/08/2019 (FB)

R&G Racing

Unit 1, Shelleys Lane, East Worldham, Alton, Hampshire GU34 3AQ.

Tel: +44 (0)1420 89007 Fax +44 (0)1420 87301 www.rg-racing.com Email: info@rg-racing.com



MONTAGEANLEITUNG FÜR ECS0141BK MOTORGEHÄUSE-PROTEKTOR



Abbildung A



Abbildung B

ALLE KIT-TEILE SIND UNTEN ABGEBILDET UND GEKENNZEICHNET.

DIE ABGEBILDETEN TEILE DIENEN LEDIGLICH ZUR ERKLÄRUNG.

ÜBERPRÜFEN SIE ZUERST, DASS ALLE TEILE VORHANDEN SIND.

LESEN SIE DIE MONTAGEANLEITUNG KOMPLETT DURCH, BEVOR SIE ANFANGEN.

WENN SIE BEI DER MONTAGE DIESES PRODUKTES UNSICHER SIND , BITTE EINEN UNSERER HÄNDLER KONTAKTIEREN ODER DAS KIT VON EINEM QUALIFIZIERTEN ZWEIRAD-MECHANIKER MONTIEREN LASSEN.

DIE VERPACKUNG DER TEILE STELLT NICHT DIE REIHENFOLGE DER MONTAGE DAR.

HINWEIS FÜR KITS MIT PLASTIKUNTERLEGSCHLEIBEN AN DEN SCHRAUBEN –
DIESE PLASTIK-UNTERLEGSCHLEIBEN WERDEN NICHT FÜR DEN EINBAU BENÖTIGT!

**EINE DIGITALE VERSION DIESER MONTAGEANLEITUNG KANN AUF
FOLGENDER SEITE HERUNTERGELADEN WERDEN:**

WWW.RG-RACING.COM

R&G Racing

Unit 1, Shelleys Lane, East Worldham, Alton, Hampshire GU34 3AQ.

Tel: +44 (0)1420 89007 Fax +44 (0)1420 87301 www.rg-racing.com Email: info@rg-racing.com

**SIE BENÖTIGEN FOLGENDES WERKZEUG**

- T30 Torx-Schlüssel
- 5mm A/F Inbusschlüssel
- Drehmomentschlüssel

ALLGEM. ANZUGSDREHMOMENT

M4 SCHRAUBE = 8Nm
 M5 SCHRAUBE = 12Nm
 M6 SCHRAUBE = 15Nm
 M8 SCHRAUBE = 20Nm
 M10 SCHRAUBE = 40Nm
 M12 SCHRAUBE = 40Nm

LIEFERUMFANG

ARTIKEL-Nr.	BESCHREIBUNG	MENGE
ARTIKEL 1	ECS0141 H.D.P.E. MOTORGEHÄUSE-PROTEKTOR (MIT 3x CS529 VORMONTIERT)	1
ARTIKEL 2	M6 x 1,0 x 60,0mm EDELSTAHL INBUSSCHRAUBE	3
ARTIKEL 3	M6 UNTERLEGSSCHEIBE (12mm O/D)	3

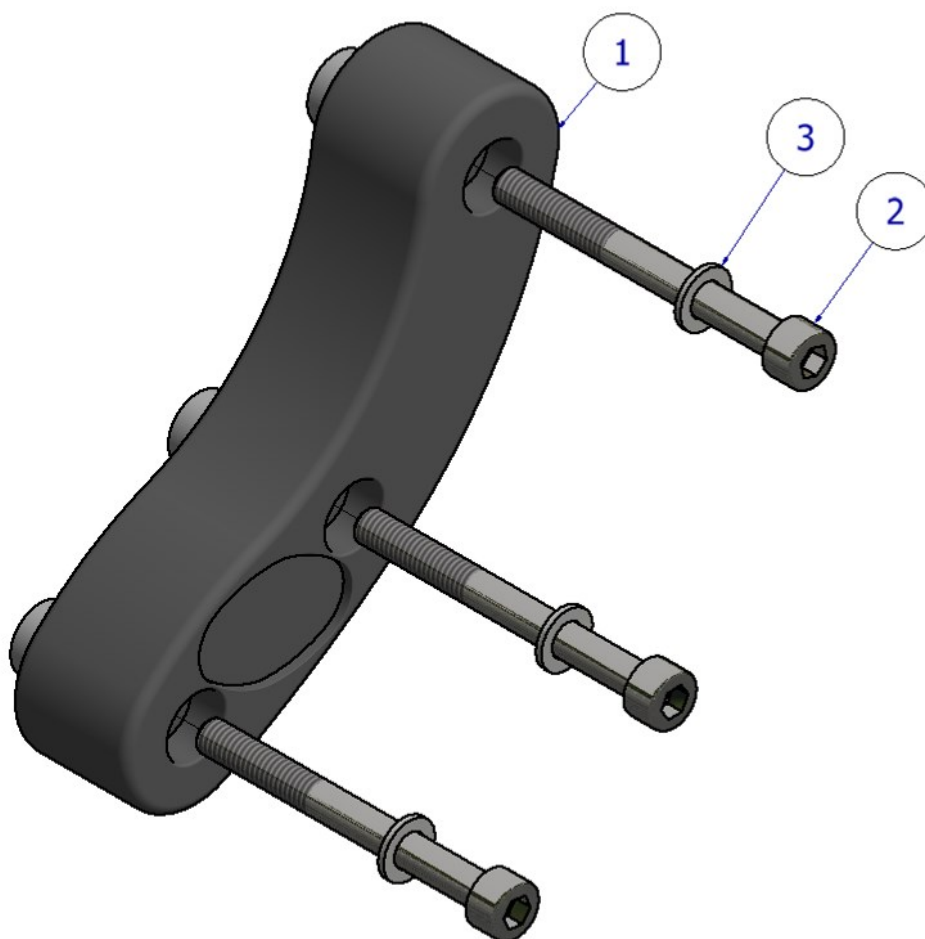
EXPLOSIONSZEICHNUNG—ZUSAMMENBAU

R&G Racing

Unit 1, Shelleys Lane, East Worldham, Alton, Hampshire GU34 3AQ.

Tel: +44 (0)1420 89007 Fax +44 (0)1420 87301 www.rg-racing.com Email: info@rg-racing.com



MONTAGEANLEITUNG

- Entfernen Sie die 3x T30 Schrauben für das Motorgehäuse, die in Abbildung 1 abgebildet sind.
- In Anlehnung an die Zeichnung auf Seite 2 sowie Abbildung 2, den R&G Motorgehäuse-Protector zusammenbauen. Eine Unterlegscheibe (Artikel 3) am jeweiligen Ende der 3x Inbusschrauben (Artikel 2) anbringen, dann die Schrauben in die 3 versenkten Montageöffnungen im Motorgehäuse-Protector (Artikel 1) einführen.
- Den zusammengebauten Motorgehäuse-Protector ans Motorgehäuse ansetzen, und mit einem 5mm Inbusschlüssel befestigen wie in Abbildung 3 abgebildet. Anschließend mit dem empfohlenen Anzugsdrehmoment des Herstellers festziehen.
- Falls noch nicht bereits montiert, einen R&G Bubble-Aufkleber am Motorgehäuse-Protector anbringen.

AUSGABE 1 - 23/08/2019 (FB)

R&G Racing

Unit 1, Shelleys Lane, East Worldham, Alton, Hampshire GU34 3AQ.

Tel: +44 (0)1420 89007 Fax +44 (0)1420 87301 www.rg-racing.com Email: info@rg-racing.com